

3 Assembling the Frame-A

First, assemble each component by following the working method and markings. Then, refer to the illustration and photos below to glue the parts

Indication of
Working Methods

Fold or Curve → Glue

Frame

Sheet C, 44 parts in total

Fold each relevant part according to the assembly symbols.

Please use the ● dots on each component as reference when gluing surfaces.

1

*Assemble both sides. The diagram shows the left side. The number inside the () is for the right side.

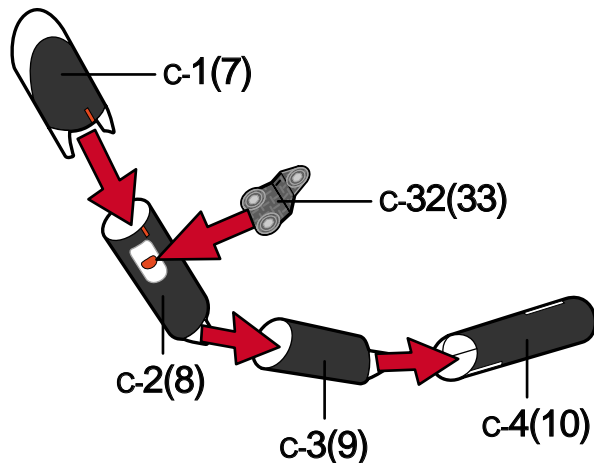

2

*Assemble both sides. The diagram shows the left side. The number inside the () is for the right side.

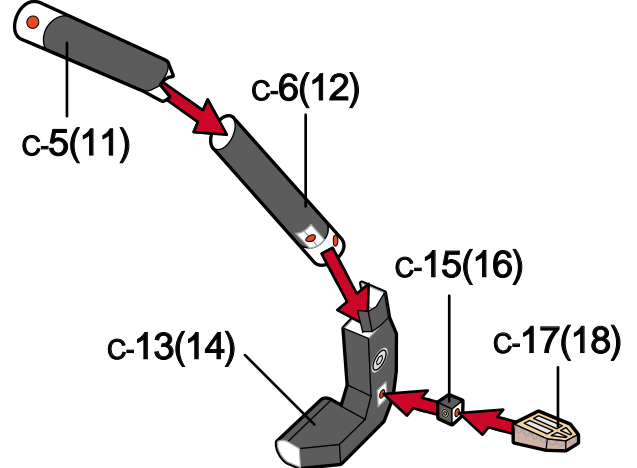

3

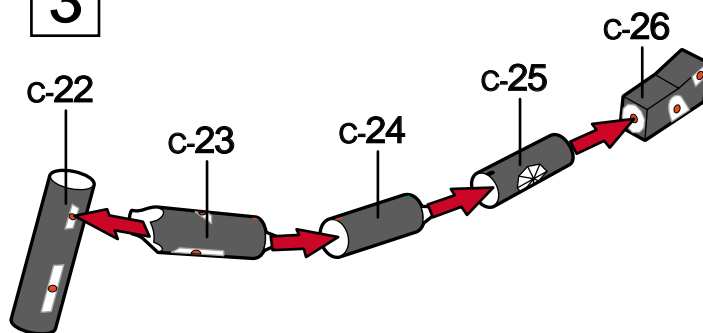

4

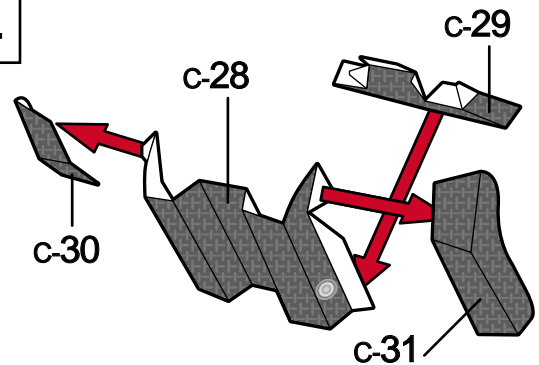

5

*Assemble both sides. The diagram shows the left side. The number inside the () is for the right side.

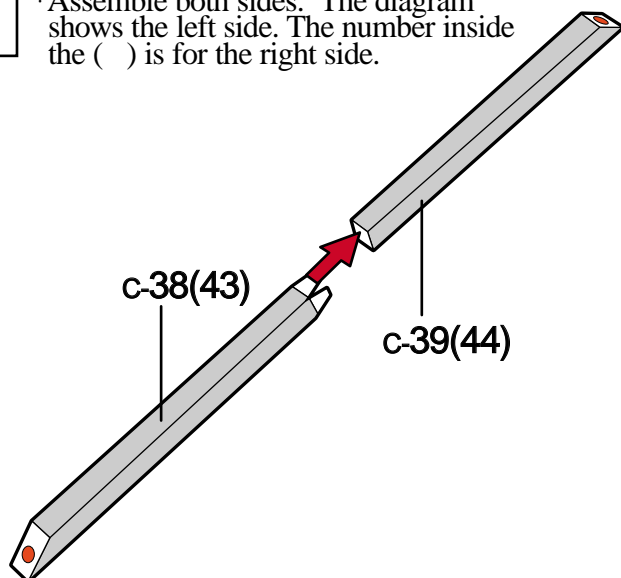

6

*Assemble both sides. The diagram shows the left side. The number inside the () is for the right side.

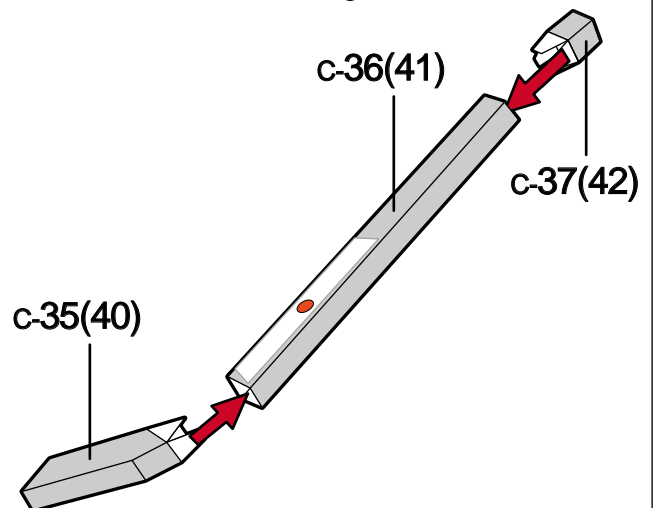

3 Assembling the Frame-B

First, assemble each component by following the working method and markings. Then, refer to the illustration and photos below to glue the parts

Indication of
Working Methods

|||||▶ Fold or Curve → Glue

Frame

Sheet C, 44 parts in total

Fold each relevant part according to the assembly symbols.

Please use the ● dots on each component as reference when gluing surfaces.

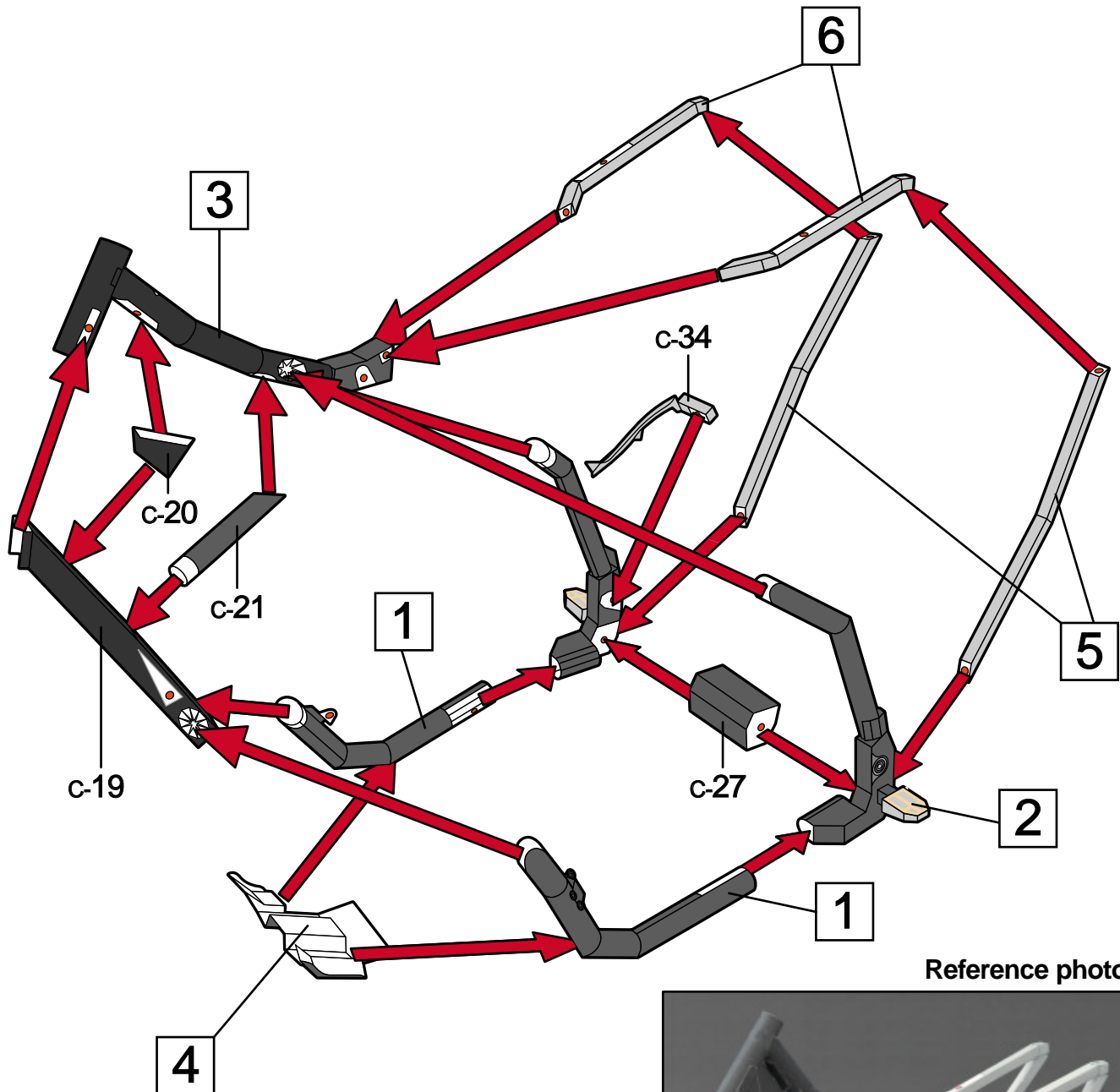

Reference photo



4 Assembling the Engine

First, assemble each component by following the working method and markings. Then, refer to the illustration and photos below to glue the parts

Indication of
Working Methods

|||▶ Fold or Curve ▶ Glue

Engine

Sheet D, 20 parts in total

Fold each relevant part according to the assembly symbols.

Please use the ● dots on each component as reference when gluing surfaces.

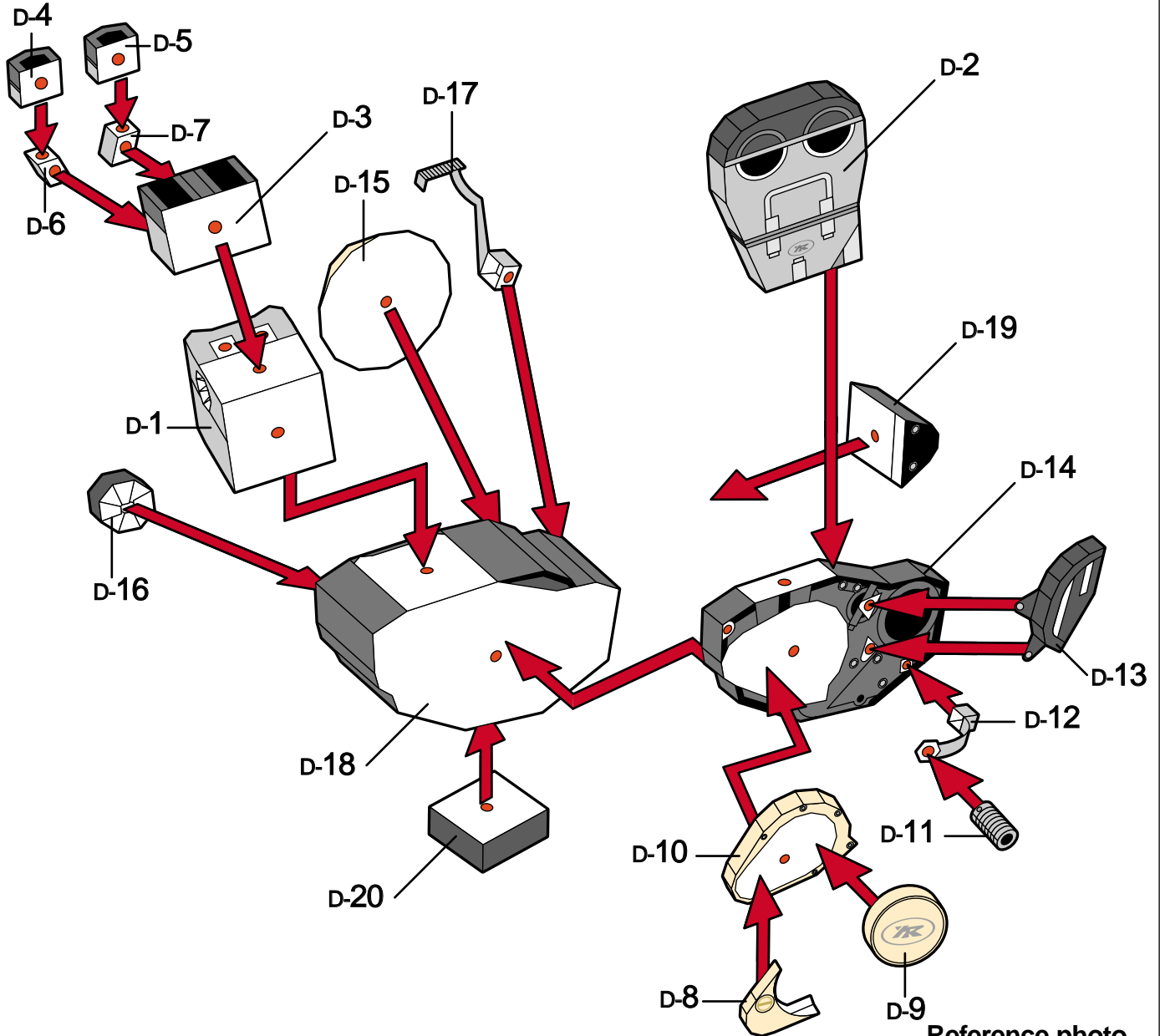

Reference photo



5 Assembling the Exhaust Pipes & Radiator

First, assemble each component by following the working method and markings. Then, refer to the illustration and photos below to glue the parts

Indication of
Working Methods

|||▶ Fold or Curve ▶▶▶ Glue

Exhaust Pipes

Sheet E, 15 parts in total

Fold each relevant part according to the assembly symbols.

Please use the ● dots on each component as reference when gluing surfaces.

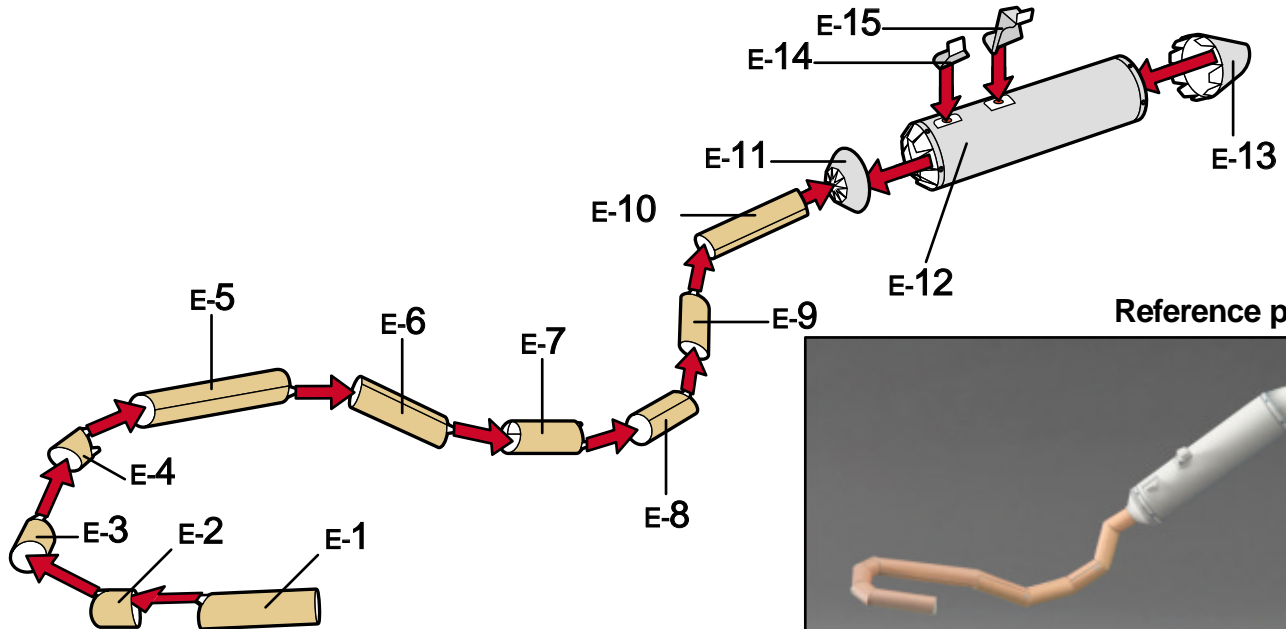

Reference photo

Radiator

Sheet E, 11 parts in total

Fold each relevant part according to the assembly symbols.

Please use the ● dots on each component as reference when gluing surfaces.

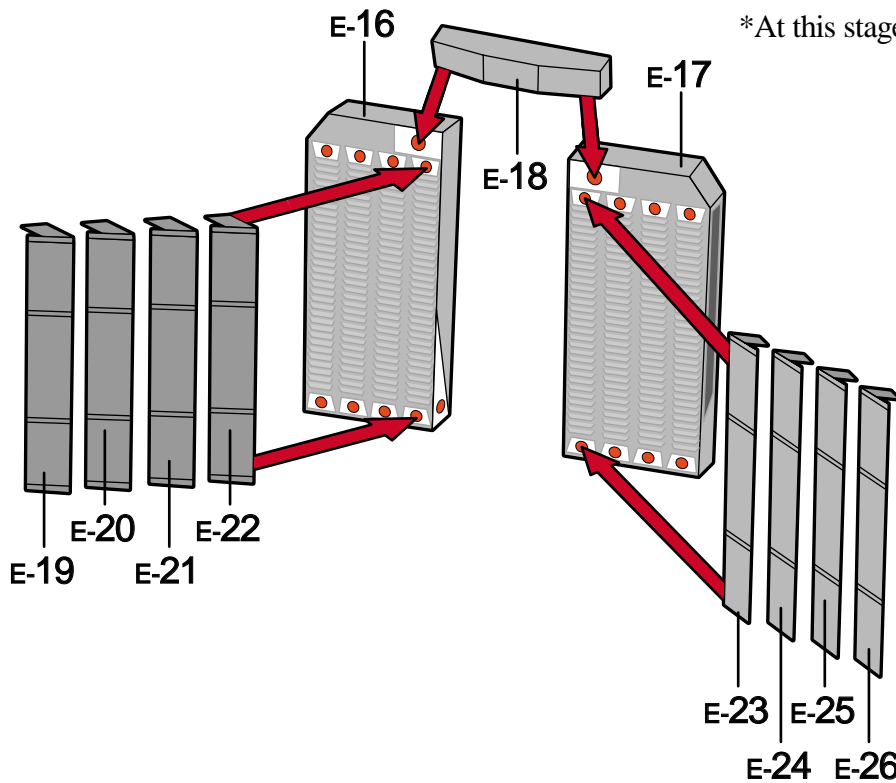

*At this stage do not glue E-16 to E-18.

Reference photo