

Harbor Breeze® is a registered trademark of LF, LLC. All Rights Reserved.

ITEM # 0003489, 0003488

OCEANSIDE CEILING FAN

MODEL # 00260, 00261

UL MODEL #OCS52

Español p. 13

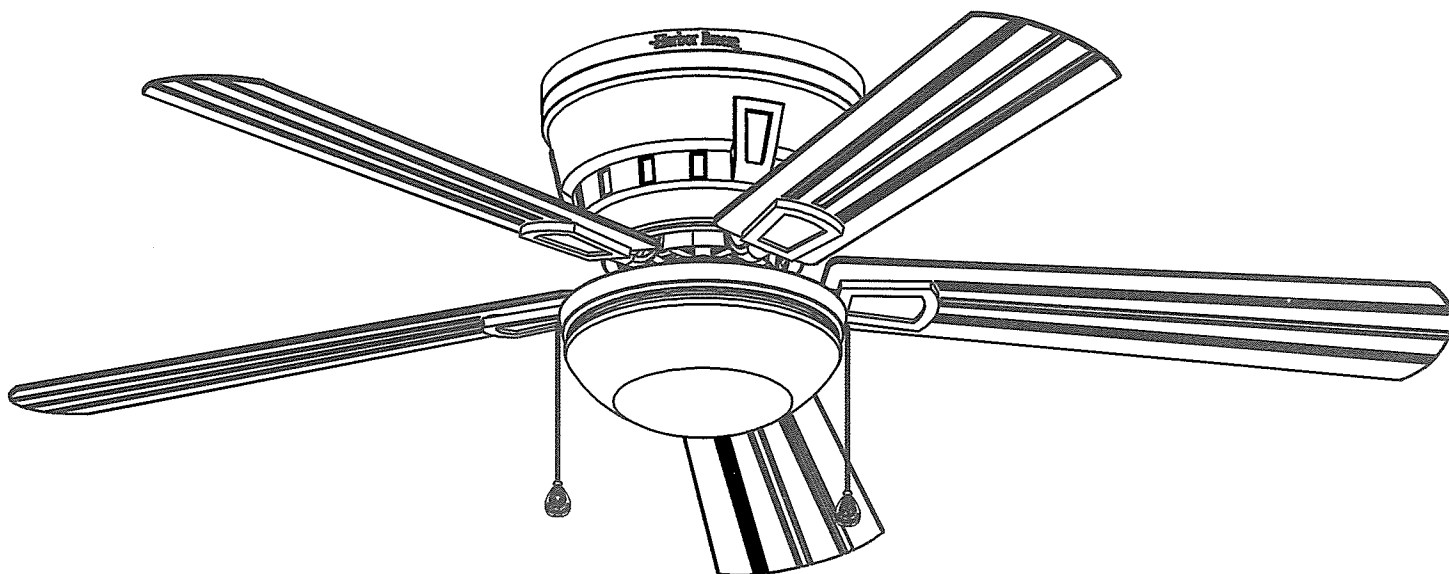

ATTACH YOUR RECEIPT HERE

Serial Number _____ Purchase Date _____



Questions, problems, missing parts? Before returning to your retailer, call our customer service department at 1-800-643-0067, 8 a.m.- 6 p.m., EST, Monday-Thursday, 8 a.m.- 5 p.m., EST, Friday.

TABLE OF CONTENTS

Safety Information 3

Package Contents 4

Hardware Contents 5

Preparation 5

Assembly Instructions 6

Operation Instructions 10

Care and Maintenance 11

Troubleshooting 11

Warranty 12

Replacement Parts List 12

SAFETY INFORMATION

READ AND SAVE THESE INSTRUCTIONS

Please read and understand this entire manual before attempting to assemble, operate or install the product. If you have any questions regarding the product, please call customer service at 1-800-643-0067, 8 a.m. - 6 p.m., EST, Monday - Thursday, 8 a.m. - 5 p.m., EST, Friday.

- When using an existing outlet box, be sure the box is securely attached to the building structure and can support the full weight of the fan, so as to avoid potential serious injury or death.
- All wiring must be in accordance with the National Electrical Code “ANSI/NFPA 70-1999” and local electrical codes. Electrical installation should be performed by a qualified licensed electrician.
- Electrical diagrams are for reference only.
- Suitable for use in Damp locations when installed in a GFCI protected branch circuit. Use only with light kits marked suitable for use in damp locations.
- Do not use bulbs having a wattage greater than the maximum value stated on the fixture and in this manual. Using a higher wattage bulb than specified will increase fixture temperature and cause risk of fire. Disconnect the electrical supply circuit to the fan before installing light kit.
- The net weight of this fan including the light kit is: 19.6 lbs. (8.9 kg)

WARNING



ELECTRIC SHOCK HAZARD

To reduce the risk of electric shock, do not use this fan with any solid-state speed control device.

WARNING



ELECTRIC SHOCK HAZARD

To reduce the risk of electric shock, make sure electricity has been turned off at the circuit breaker or fuse box before beginning installation.

CAUTION

PERSONAL INJURY HAZARD

To reduce the risk of injury to persons, install fan so that the blade is at least 7 ft. (2,1 m) above the floor.

WARNING



PERSONAL INJURY HAZARD

Reduce the risk of personal injury, do not bend the blade brackets when installing the brackets, balancing the blades, or cleaning the fan. Do not insert foreign objects in between rotating fan blades.

WARNING



FIRE, ELECTRICAL SHOCK OR PERSONAL INJURY HAZARD

To reduce the risk of fire, electric shock, or personal injury, mount to outlet box marked “ACCEPTABLE FOR FAN SUPPORT OF 15.9 KG (35 LBS) OR LESS” and use mounting screws provided with the outlet box. Most outlet boxes commonly used for the support of lighting fixtures are not acceptable for fan support and may need to be replaced. Consult a qualified electrician if in doubt.

PACKAGE CONTENTS

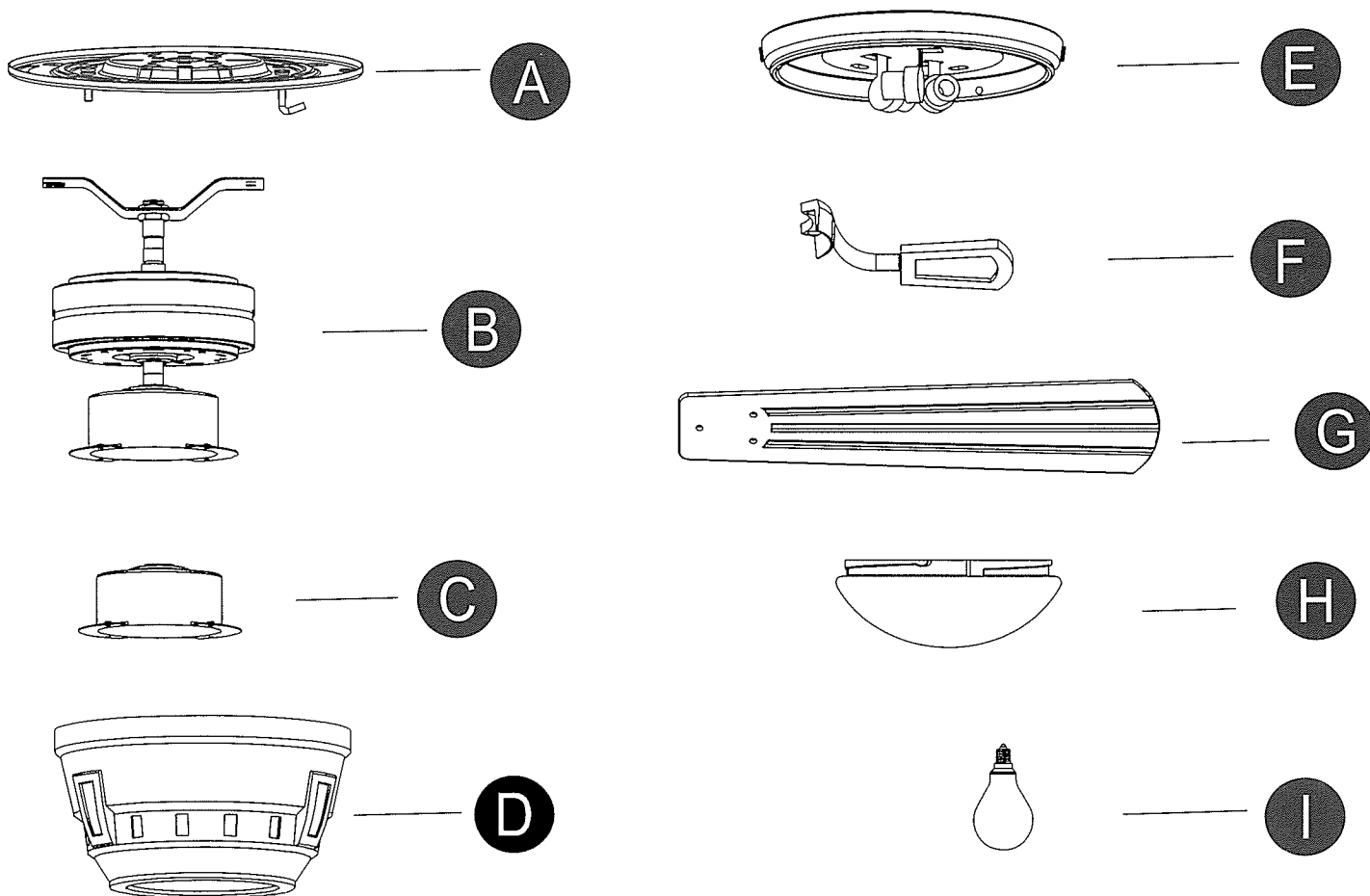

PART	DESCRIPTION	QUANTITY
A	Mounting Plate	1
B	Fan Motor	1
C	Switch Housing (attached to the fan motor)	1
D	Motor Housing	1
E	Light Fitter Assembly	1
F	Blade Bracket	5
G	Blade	5
H	Glass	1
I	Bulb	3

HARDWARE CONTENTS (shown actual size)

AA

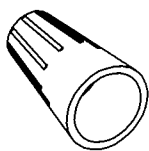

Wire connector
Qty. 4

BB



Fan pull chain extension
Qty. 1
(NOT TO SCALE)

CC



Light pull chain extension
Qty. 1
(NOT TO SCALE)

DD



Locknut
Qty. 3

EE

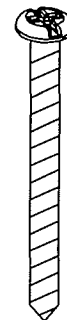

Extra wood screw
Qty. 2

FF



Extra mounting spring
lock washer
Qty. 2

GG

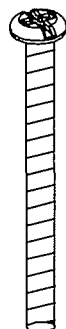

Extra long mounting screw
Qty. 2

HH



Extra mounting flat washer
Qty. 2

II



Extra mounting star washer
Qty. 2

JJ



Blade screw
Qty. 16

PREPARATION

Before beginning assembly of product, make sure all parts are present. Compare parts with package contents list and hardware contents above. If any part is missing or damaged, do not attempt to assemble the product. Contact customer service for replacement parts.

Estimated Assembly Time: 45 minutes

Tools Required for Assembly (not included): Phillips screwdriver, step ladder, electrical tape, pliers, wire cutter, wire stripper.

ASSEMBLY INSTRUCTIONS

7. Attached a blade (G) to a blade bracket (F) using the blade screws (JJ) as shown in Step 7. Start a blade screw (JJ) and a blade washer into the blade bracket (F). Repeat for the remaining blade screws (JJ) and blade washers. Tighten each blade screw (JJ) securely.

Hardware Used

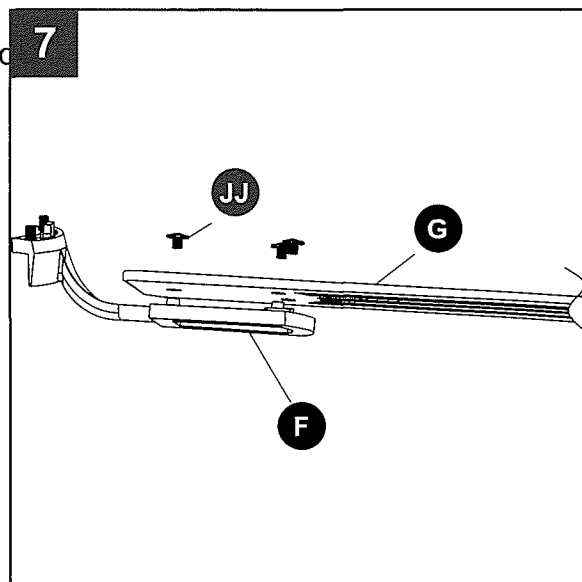
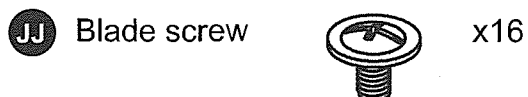

8. Fasten the blade bracket (F) to the fan motor by inserting the alignment post into the slot on the bottom of the motor and tightening the blade bracket screws with washers. Please note that the blade bracket screws with washers are pre-installed into the blade bracket (F). Repeat the steps for the remaining blades (G) and blade brackets(F).

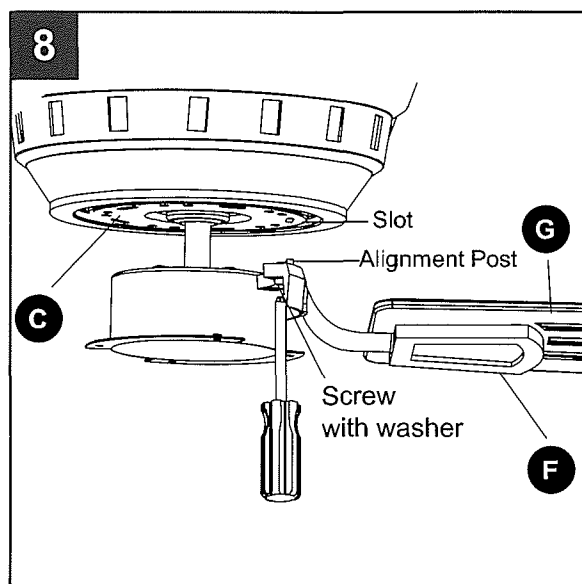

9. Remove the screw (with a arrow label) on the switch housing (C) below the fan motor. Loosen but do not remove the other three screws.

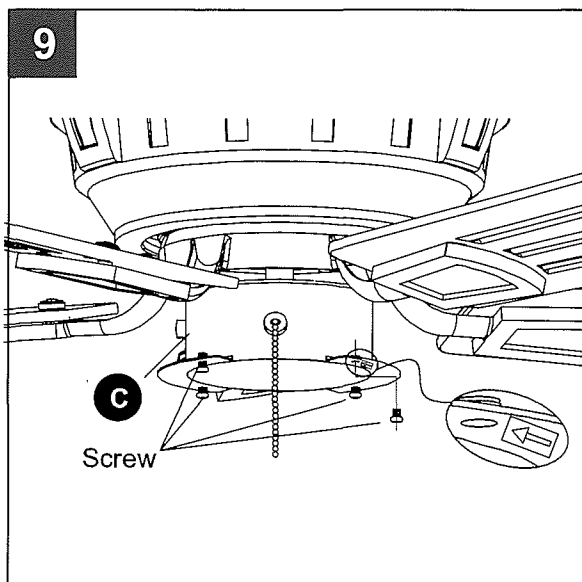

ASSEMBLY INSTRUCTIONS

10. Connect the blue and white wires exiting the switch housing (C) below the fan motor with the black and white wires from the light fitter assembly (E) by connecting the plugs (blue to black; white to white). Carefully push all wires back into the switch housing (C).

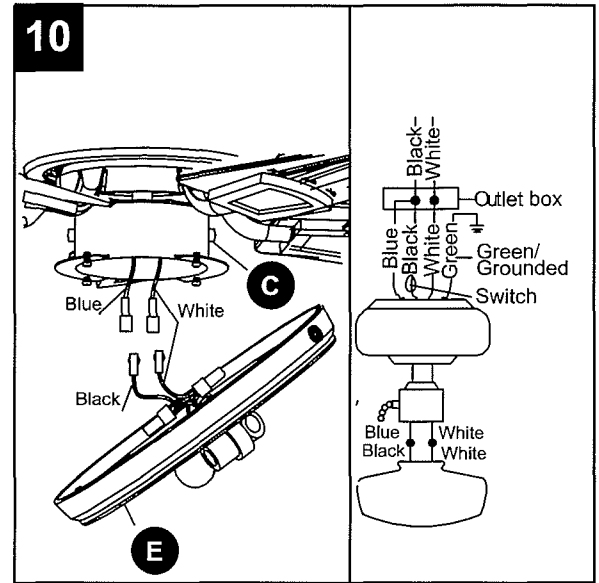

11. Align the three key slots in the light fitter assembly (E) with the three screws on the switch housing (C) that were loosened in step 9. Place the light fitter assembly (E) over the three screws, turn the light kit assembly (E) clockwise until it locks, tighten the three screws. Re-install the screw that were removed in step 9 and tighten firmly.

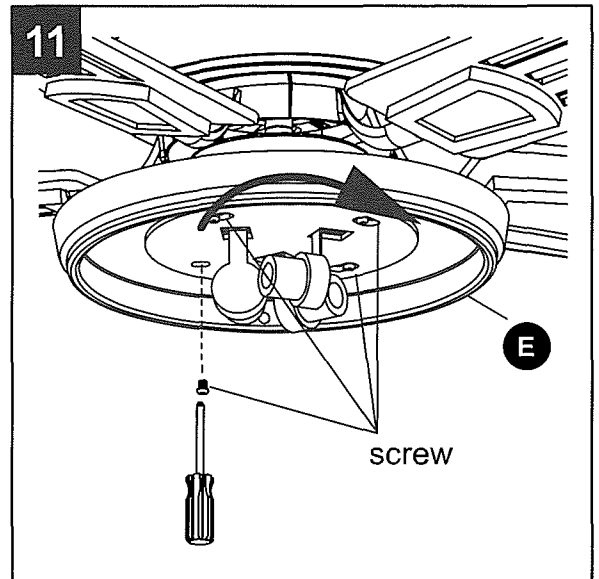

12. Install three 40 watt Candelabra base Type A15 bulbs (I) to socket.

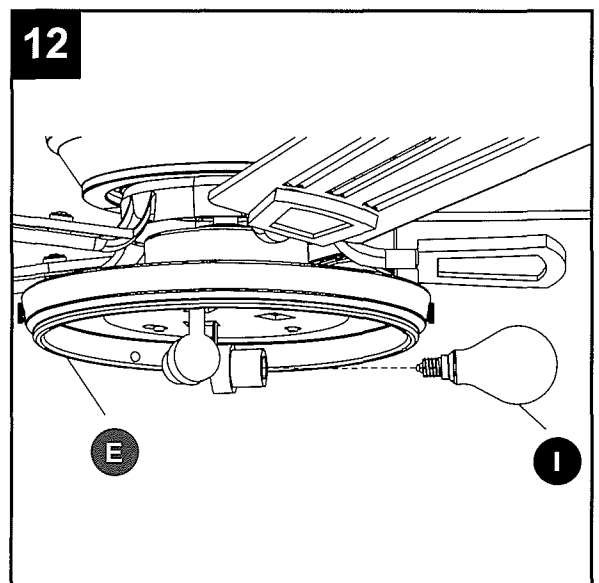

ASSEMBLY INSTRUCTIONS

13. Place the glass (H) into light fitter assembly (E), aligning three flat areas on the top flange of the glass (H) with the three raised dimples in the light fitter assembly (E). Turn the glass clockwise until it stops.

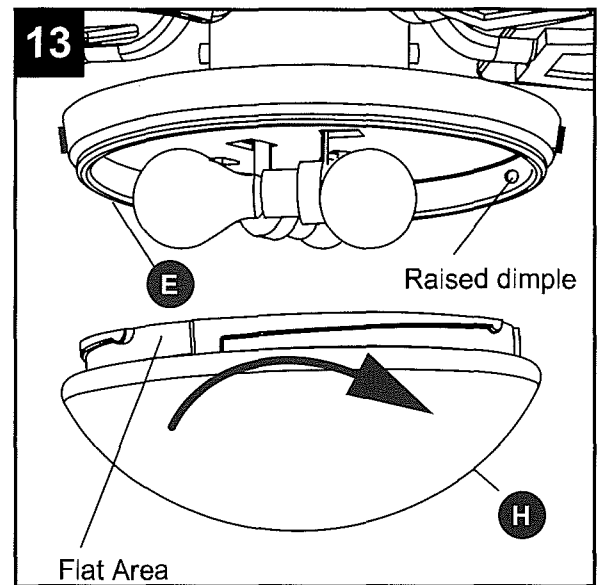

14. Pass the pull chains through the pull chain nuts on the light fitter assembly (E). Attached the fan pull chain extension (BB) to the speed pull chain, labeled FAN on the switch housing (C). Attached the light kit pull chain extension (CC) to the light pull chain, labeled LIGHT on the switch housing (C).

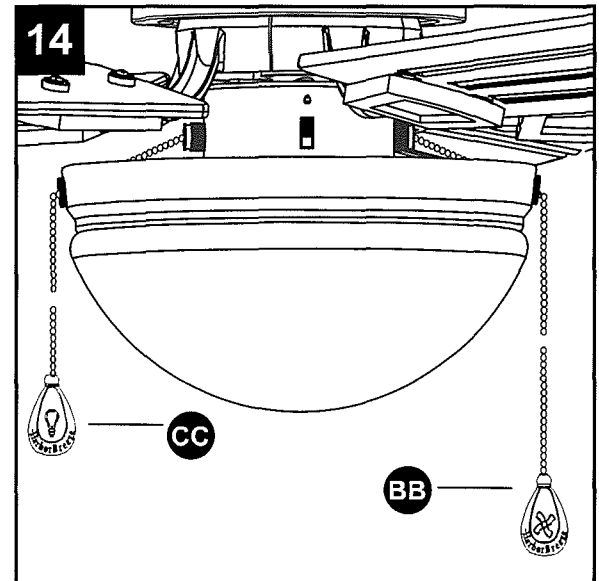

Hardware Used

- BB** Fan pull chain extension x 1
- CC** Light pull chain extension x 1

OPERATION INSTRUCTIONS

1. PULL CHAIN:

- (1). The fan pull chain, labeled FAN on the switch housing (C), has four positions. One pull is HIGH, two pulls is MEDIUM, three is LOW and four turns the fan OFF.
- (2). Pull the light pull chain, labeled LIGHT on the switch housing (C), to turn the light ON or OFF.

2. REVERSE SWITCH:

When the season changes, you may want to change the direction your fan spins. To switch between clockwise and counterclockwise rotation, flip the fan reversal switch.

NOTE: Wait for fan to stop before reversing the switch.

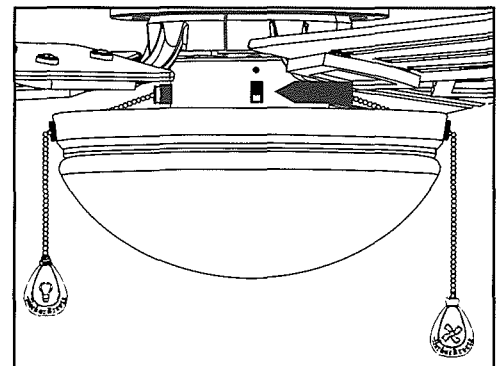

2A. In cooler weather, clockwise rotation creates an upward airflow, which moves hot air from the ceiling into room. Push the switch UP and see a Snowflake icon.

2B. In warmer weather, counterclockwise rotation creates a downward air flow, which cools the air. Push the switch DOWN and see a Sun icon.

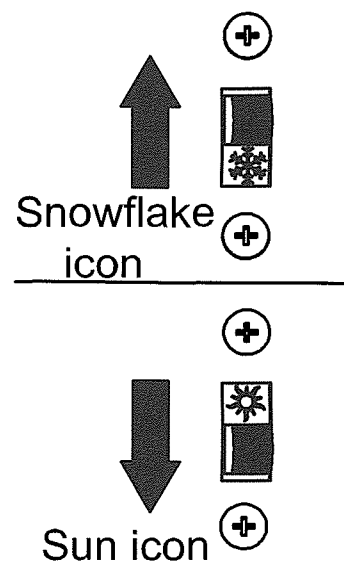

CARE AND MAINTENANCE

- **Important:** Shut off main power supply before beginning any maintenance. Do not use water or a damp cloth to clean the ceiling fan.
- At least twice each year, lower motor housing to check fan motor assembly, and then tighten all screws on the fan.

Clean fan housing with only a soft brush or lint-free cloth to avoid scratching the finish. Clean blades with a lint-free cloth. You may occasionally apply a light coat of furniture polish to blades for added protection.

TROUBLESHOOTING

If you have any questions regarding the product, please call customer service at 1-800-643-0067, 8 a.m. - 6 p.m., EST, Monday - Thursday, 8 a.m. - 5 p.m., EST, Friday.

PROBLEM	POSSIBLE CAUSE	CORRECTIVE ACTION
Fan does not move.	<ol style="list-style-type: none"> 1. Chain switch is "off". 2. Fan reversal switch not engaged. 3. Power is off or fuse is blown. 	<ol style="list-style-type: none"> 1. Pull chain switch. 2. Push switch firmly either way. 3. Turn power on or check fuse. 4. Turn power off. Loosen motor housing, check all connections.
Noisy operation.	<ol style="list-style-type: none"> 1. Blades are loose. 2. Cracked blade. 3. Non-approved speed control. 	<ol style="list-style-type: none"> 1. Tighten all blade screws. 2. Replace blades (call customer service). 3. Replace with an approved speed control device.
Excessive wobbling.	<ol style="list-style-type: none"> 1. Unbalanced blades. 2. Blades are loose. 3. Blade brackets incorrectly attached. 4. Fan not securely mounted. 	<ol style="list-style-type: none"> 1. use balanced kits. 2. Tighten all blade screws. 3. Reinstall blade brackets. 4. Turn off power. Carefully loosen motor housing, remount securely.

LIMITED LIFETIME WARRANTY

Chien Luen Industries warrants this fan to be free from defects in workmanship and material present at time of shipment from the factory for life (with limitations) from the date of purchase. This warranty applies only to the original purchaser. The manufacturer agrees to correct such defect at no charge or at our option replace the ceiling fan with a comparable or superior model.

To obtain warranty service, present a copy of your sales receipt as proof of purchase. All cost of removal and reinstallation are the expressed responsibility of the purchaser. Any damage to the ceiling fan by accident, misuse or improper installation, or by affixing accessories not produced by this warranty, are at the purchaser's own responsibility. Chien Luen Industries assumes no responsibility whatsoever for fan installation during the lifetime limited warranty. Any service performed by an unauthorized person will render the warranty invalid.

Due to varying climatic conditions, this warranty does not cover changes in brass finish, rusting, pitting, tarnishing, corroding or peeling. Brass finish fans maintain their beauty when protected from varying weather conditions. Any glass provided with this fan is not covered by the warranty.

Any replacement of defective parts for the ceiling fan must be reported within the first year from the date of purchase. For the balance of the warranty, call our customer service department at 1-800-643-0067 for return authorization and shipping instructions so that we may repair or replace the ceiling fan. Any fan or parts returned improperly packaged is the sole responsibility of the purchaser. There is no further expressed warranty. Chien Luen Industries disclaims any and all implied warranties.

The duration of any implied warranty which can not be disclaimed is limited to the lifetime limited period as specified in our warranty. Chien Luen Industries shall not be liable for incidental, consequential or special damages arising at or in connection with product use or performance except as may otherwise be accorded by law. This warranty gives you specific legal rights and you also have other rights which vary from state to state. This warranty supersedes all prior warranties.

Da Che Industrial Area Nanlang, Zhongshan, Guangdong, China 528451

Note: A small amount of "wobble" is normal and should not be considered a defect.

REPLACEMENT PARTS

For replacement parts, call our customer service department at 1-800-643-0067, 8 a.m.-6 p.m., EST, Monday-Thursday, 8 a.m.-5 p.m., EST, Friday.

PART	DESCRIPTION	PART#
A	Mounting Plate	102400-0011
E	Light Fitter Assembly	105000-0419
F	Blade Bracket	101000-0224
G	Blade	108003-3018
H	Glass	991300-0390
BB	Fan Pull Chain Fob	990537-0031
CC	Light Kit Pull Chain Fob	990537-0032
JJ	Blade Screw	119000-2051

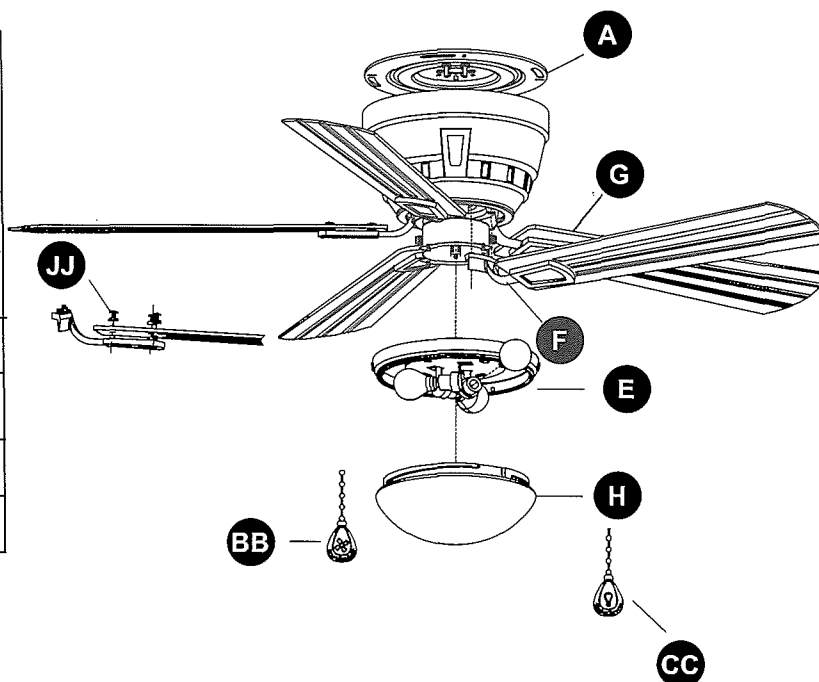

Printed in China